

-NOTES-

1. MATERIAL: PORCELAIN, LIGHT GRAY
2. STAMPED WITH:
 -"HPS"
 -MANUFACTURER ID
 -COUNTRY OF ORIGIN
 -ANSI CLASS
 -DATE CODE (MM/YYYY)
3. USED TO ISOLATE SECTIONS OF THE GUY WIRE.
4. MEETS ANSI/NEMA C29.4
5. FOR INSULATORS WITH "MER" SUFFIX (EX. C9091042MER), ISULATOR WILL BE BROWN AND INCLUDE "MERALCO" STAMP.

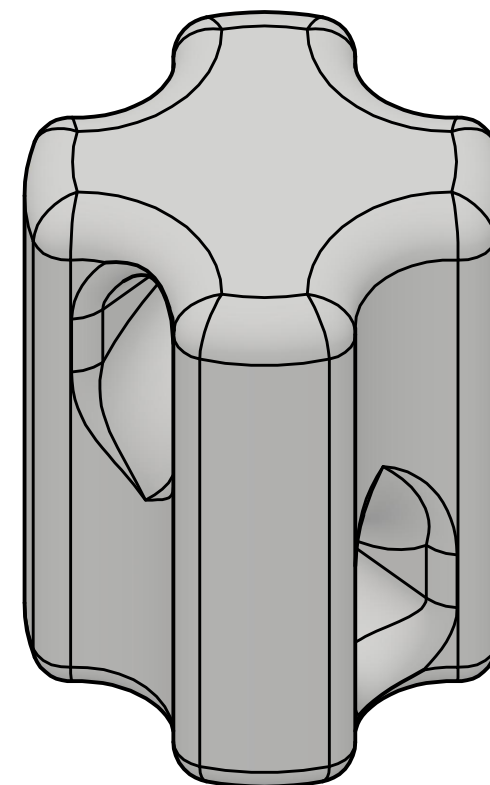

CATALOG NUMBER	ANSI CLASS	TENSILE STRENGTH (LBS)	MAX. CABLE DIAMETER	"A"	"B"	"C"	"D"	"E"
C9091041	54-1	10,000	3/8	5/8	1 3/4	3 1/2	2 1/2	1 3/4
C9091042	54-2	12,000	1/2	7/8	2 1/4	4 1/4	2 7/8	2 1/8
C9091042MER	54-2	12,000	1/2	7/8	2 1/4	4 1/4	2 7/8	2 1/8

CHANCE [®]	HUBBELL POWER SYSTEMS, INC.	
	TITLE INSULATOR GUY-STRAIN	
CONFIDENTIAL: THIS DRAWING AND ITS CONTENTS ARE CONFIDENTIAL AND THE EXCLUSIVE PROPERTY OF HUBBELL POWER SYSTEMS. NO PUBLICATION, DISTRIBUTION, OR COPIES MAY BE MADE WITHOUT THE WRITTEN CONSENT OF HUBBELL POWER SYSTEMS. HUBBELL POWER SYSTEMS UNPUBLISHED ALL RIGHTS RESERVED UNDER THE COPYRIGHT LAWS.	SIZE B	CAT / PART / ASSY NO. SEE CHART
DO NOT SCALE THIS DRAWING	DRN BY HOEK	DWG NO. SA9091041
		REV E
	DATE 3/30/22	SHEET 1 OF 1